

263
371
76

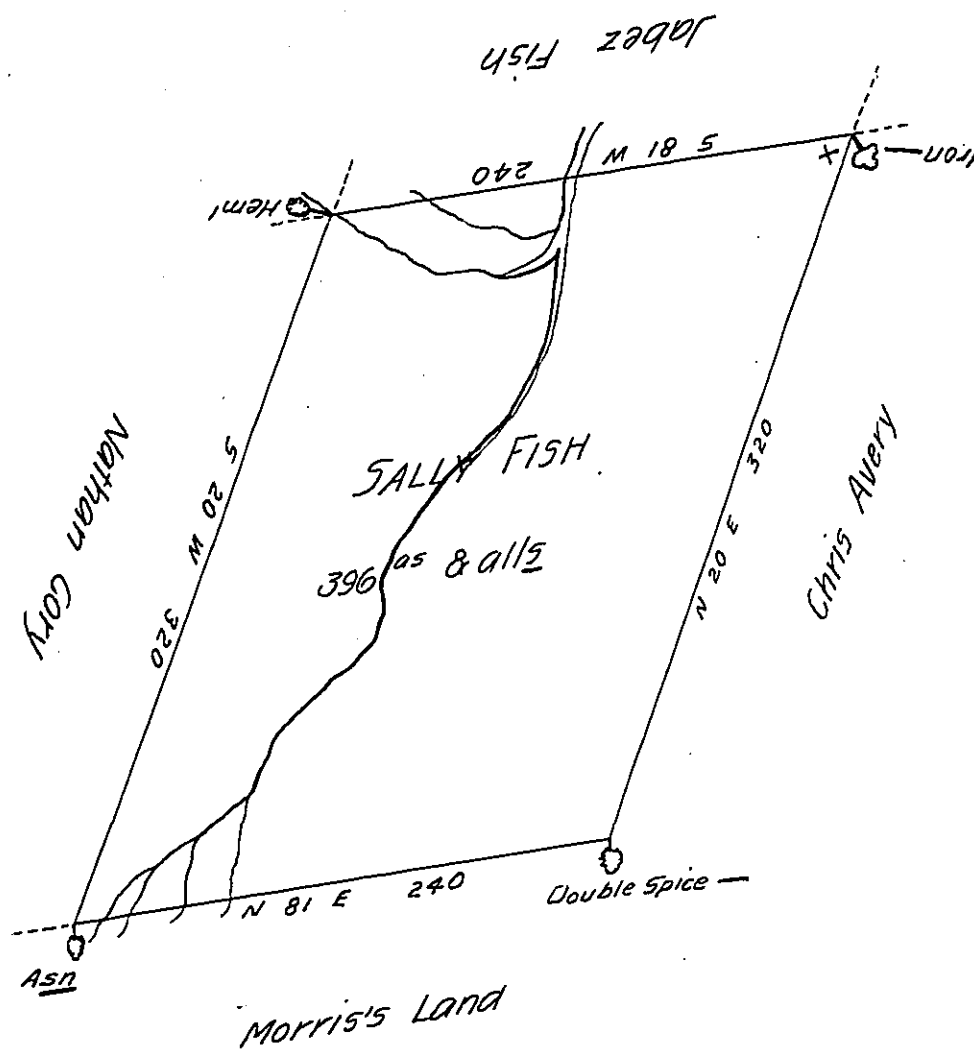

By Virtue of a Warr^t dated 20th August 1792 Surveyed the 27th of October 1792 Unto Sally Fish the above described tract of Three hundred and ninety six acres of land and allowance situated on a branch of Sugar Creek in Luzerne County

By Wm Montgomery D.S.

To Daniel Brodhead Esq^r

Jo J. Wallis D.S.

Surv^r Gen^l of Pensylv^a

N-2

IN TESTIMONY that the above is a copy of the original remaining on file in the Department of Internal Affairs of Pennsylvania, made conformably to an Act of Assembly approved the 16th day of February, 1833, I have hereunto set my Hand and caused the Seal of said Department to be affixed at Harrisburg, this thirtieth day of September 1904

Joseph P. Brown
Secretary of Internal Affairs.